

CBS110/120/130 Sink and Tap
Manual for Installation, Use and Maintenance

|C|D|A|



Single Lever Tap

Installation

Ensure that the collar (G in fig. 2) is fully tightened by hand before installation. Failure to do so may cause the tap to leak when the water is turned on.

Please note: before starting switch off and drain the water heating system and turn off the water supply at the main stop cock.

Before installing the tap it is essential that you flush through the supply pipes thoroughly to remove any remaining swarf, solder or other impurities. Failure to carry out this simple procedure could cause problems or damage to the workings of the mixer.

1. Screw the flexible tail pipes into the tap body.

Please note: exceeding the recommended torque of 10Nm may damage the connection.

2. Insert the flexible tail pipes and body into the sink. Assemble the tap as shown in figure 1.
3. After installing the tap unscrew the aerator and open both the water flow systems in order to remove any working impurities.

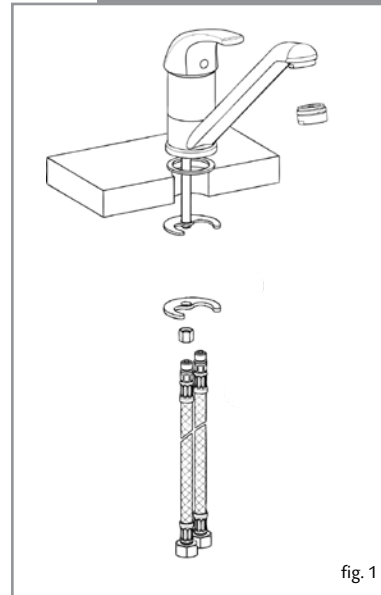

fig. 1

Care and maintenance

- Taps should only be cleaned with a damp cloth or sponge, and dried with a soft cloth.
- Do not use chemical or cream cleaners, or solutions with bleach content. This can affect the finish of the tap.

Please ensure any cloth that has been used with such cleaners is rinsed thoroughly before being used on tap.

DO NOT USE ABRASIVE OR WIRE CLEANERS.

Replacing the tap cartridge

1. Remove the plastic cap A.
2. Unscrew screw B using a 2.5mm allen key.
3. Remove the tap handle C.
4. Remove the cap D.
5. Unscrew screw E using a 30mm key.
6. Remove and replace the cartridge (F)

Please note: When replacing screw E, use a torque wrench set to 10Nm.

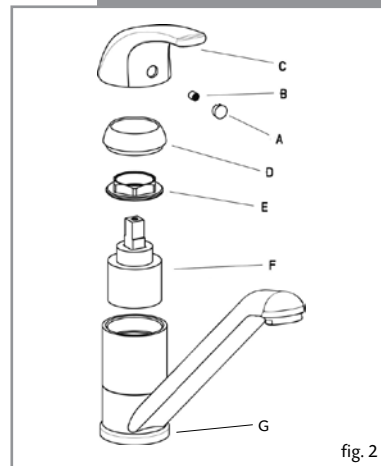

fig. 2

Stainless Steel Sinks

Taking care of your sink

Your CDA sink is manufactured using material developed specifically to withstand the rigours of everyday kitchen use. However, we advise you to follow these precautions to keep the sink in pristine condition:

- Do not use a plastic washing-up bowl in the sink as grit and other particles may become embedded in the bowl and scratch or erode the sink surface. CDA specifically recommend the use of wire sink-baskets and drainer-racks to help protect your sink. Take care to not cut the plastic coating on these accessories with sharp cutlery or the edges of pans, etc.
- Do not use neat bleach or other harsh cleaning agents on the metal sink waste as this may cause tarnishing. This is especially important if the waste is of the brass/brass finish type.
- Avoid dropping heavy or sharp objects into the sink as they may scratch or damage the surface.
- The surface of the sink can be affected by certain chemicals e.g. neat bleach, nail polish remover, paint stripper, solvents, brush cleaner and insecticides. If any of these substances come into contact with the sink, wipe off immediately with a dry cloth, wash with mild detergent and rinse with water.
- Do not use abrasive liquids, powders or steel pads to clean the sink as they will damage the sink surface and make it more susceptible to staining. The sink may be cleaned with a dilute bleach solution.
- In hard-water areas, a limescale deposit may build up on the sink. The limescale may become stained by coloured foods such as coffee or red wine. If this occurs, we recommend use of a mild limescale remover.
- Particularly stubborn organic stains can be removed effectively by soaking the sink in a biological washing-powder solution, dishwasher powder solution or diluted bleach.
- If the sink comes into contact with acidic materials, rinse immediately with plenty of water and wipe with a soft dry cloth.
- Do not leave rusty objects in contact with the sink. Rust can cause staining, cracking or even permanent damage to the sink surface.
- To avoid staining of the surface do not leave food or other materials with corrosive properties such as juices, salt, vinegar, mustard etc. on the sink for a long time.
- After using the sink, rinse it clean with warm soapy water and rinse with clean water before wiping dry.
- During installation, protect from scratches, scuffs and other damage.
- Do not overtighten or strain plumbing fittings.
- The moulding and edges of the sink must be absolutely level so water flows off the drainer.



Important information about your sink and tap

Although stainless steel sinks are built to last a lifetime, consumers are almost always concerned about three specific natural occurrences that may appear on their new sink.

Scratching

Stainless steel is **NOT** scratch resistant and is susceptible to scratching through normal wear. Scratches are most prevalent when the sink is brand new but through continual use, scratches will become more uniform and less apparent over time.

Rust spots

Rust coloured spots which may appear on a new sink do not indicate that the sink itself is rusting. The appearance of these spots is attributed to external factors most commonly related to ferrous particles which come through the water supply following the installation of new pipe work. These particles are not visible to the eye until they start to rust and are likely to appear in the first six to twelve months of use. Cleaning may remove the rust stain but not eliminate the cause. It is however important to avoid the use of steel wool which will exacerbate the problem.

Water staining

Limescale deposits and 'rainbow' discolouration which may appear on a stainless steel surface are solely due to environmental factors and not inherent faults within the product. Through continuous use and regular cleaning, these effects will disappear.

Your guarantee is valid providing that

- The product has been installed by a suitably qualified person.
- Installation has been carried out in accordance with instructions and current legislation.
- Proof of purchase can be produced.
- The product has been used for domestic purposes only.
- The product has not been tampered with or repair attempted or modified by any unauthorised person.
- All products have been installed in accordance local water by laws and any building regulations in force

Your guarantee does not cover

- Damage by misuse, neglect or transit.
- Use of parts not used or recommended by CDA.
- Routine maintenance, general wear and tear and installation faults.
- Products used for commercial or professional purposes.

Your sink and tap is guaranteed against defects in materials and/or workmanship for 5 years. At the discretion of CDA, should a fault arise the sink may be repaired or replaced and agreed refitting may be reimbursed on receipt on a faulty sink/part, once they have been inspected and deemed faulty.

To contact our Customer Care Department, or for Service,
please contact us on the details below.